



ESTATE AGENTS & VALUERS

61 Boundary Road
Hove
Sussex
BN3 5TD

01273 00 99 66
coxandcohomes.co.uk



- 1 Bedroom Flat with Patio Garden
- Open plan Kitchen
- Popular Brunswick Location
- Sought after Brunswick Location
- Double Bedroom
- Walk in Wardrobe
- Close to Hove seafront
- Simply a must view

Brunswick Square

Price: £325,000 Leasehold

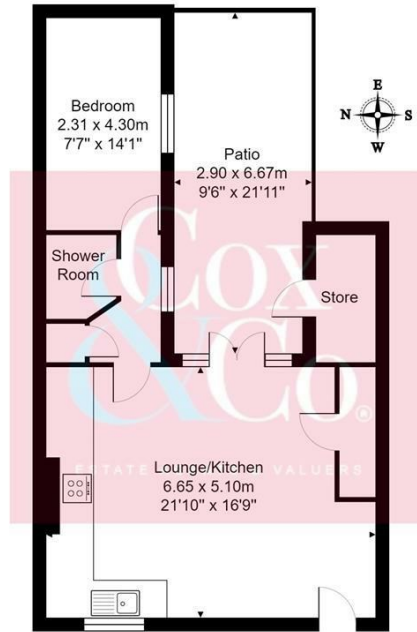

Total Area: 53.2 m² ... 573 ft² (excluding patio)

All measurements are approximate and for display purposes only. Copyright 'GREEN PROPERTIES' 2020

A stunning one bedroom converted patio garden apartment located in the most sought after Brunswick district of Hove. this is a unique flat, situated within a Grade I listed building.

The property has a modern fitted open plan kitchen, diner, and living space. Large feature double doors open out onto a lovely private garden patio. There is a double bedroom and a separate modern fitted shower room suite.

The apartment has plenty of storage throughout including a large walk-in wardrobe. The outside space has been converted into a good size storage room providing even more room currently used for patio furniture and barbecue items.

The apartment is located 2mins walk from Hove's stunning lawned seafront. Additionally, Brunswick Square's secluded park is right outside the building providing another social area to enjoy.

Brighton City Centre and Station is only a 20-minute walk away, great for commuting with direct links to London and Gatwick airport. There is plenty of access to a variety of bus routes with many shops, gyms and leisure activities surrounding this sought after area.

