

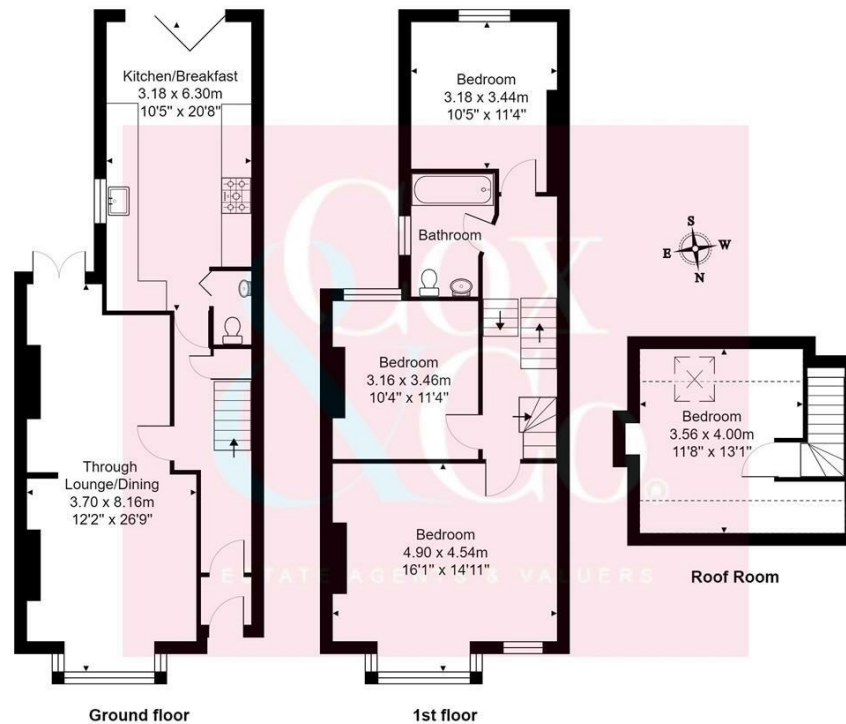

- **Stunning Period House**
- **South Facing Rear Garden**
- **Original Features**
- **Superb Kitchen / Diner**
- **Simply A Must View**
- **Four Bedrooms One Loft Room**
- **End Of Terrace (semi detached)**
- **Popular & Central Location**
- **Fantastic Decorative Order**

# **St. Andrews Road, Portslade, Brighton**

**Price: £575,000 Freehold**



Total Area: 132.1 m<sup>2</sup> ... 1422 ft<sup>2</sup>

All measurements are approximate and for display purposes only. Copyright 'GREEN PROPERTIES' 2020

Superb four bedroom semi-detached (end of Terrace) period house, that benefits from having a through lounge/diner a lovely contemporary kitchen with underfloor heating which opens out to a fantastic south facing walled rear garden which for a house so centrally located is uniquely not overlooked and really does offer a good degree of privacy.

All four of the bedrooms are of a good size making this an ideal family home.

The property is ideally located just off Boundary Road in West Hove and is very close to shops, bars, and cafés. Portslade mainline railway station is only 0.3 miles away and there are excellent bus services into Brighton & Hove city centres.

A residents parking scheme is currently under consultation - <https://consultations.brighton-hove.gov.uk/parking/south-portslade-residents-parking/>

