

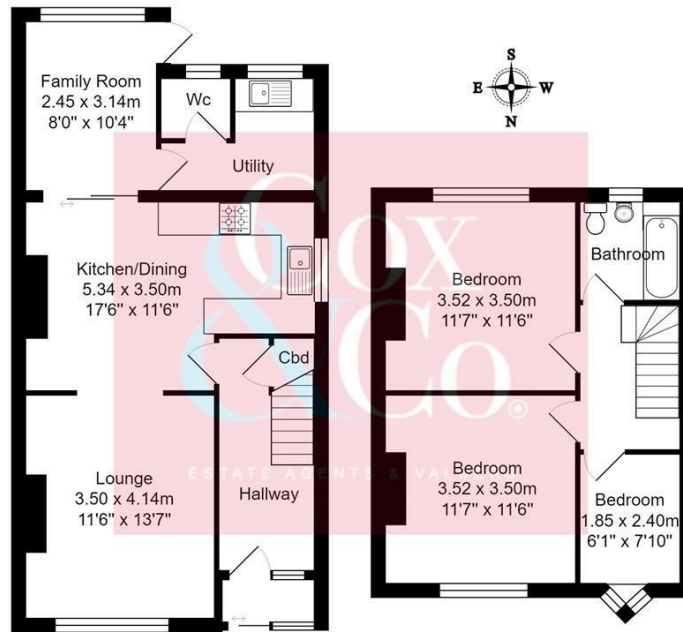

- Three Bedroom End of Terrace House
- Southerly Aspect Rear Garden
- Kitchen Breakfast Room
- Utility Room with WC
- Land At Rear / Private Allotment
- Garage & Additional Parking
- Family Dining Room
- Close To Southwick Square & Station

# The Gardens, Southwick, Brighton

Price: £425,000 Freehold



Total Area: 95.5 m<sup>2</sup> ... 1028 ft<sup>2</sup>

All measurements are approximate and for display purposes only. Copyright 'GREEN PROPERTIES' 2021

Cox & Co are pleased to offer this three-bedroom end of terrace house located just 0.5 miles from excellent shopping facilities in Southwick Square and Southwick mainline train station offering services to both Brighton & London city centers.

Ideal for the 'Grow Your Own and Self Sufficient' enthusiast as the property has a separate allotment area laid out with vegetable beds, paths, and a greenhouse.

Subject to the usual consents the additional land also has great potential for the provision of extra accommodation such as a home office, gym, or possibly a residential annex.

The house does require some updating but it would still make a fantastic family home with the bonus and rare opportunity of having its own adjoining allotment.

For viewing please call Cox&Co on 01273 00 99 66

