

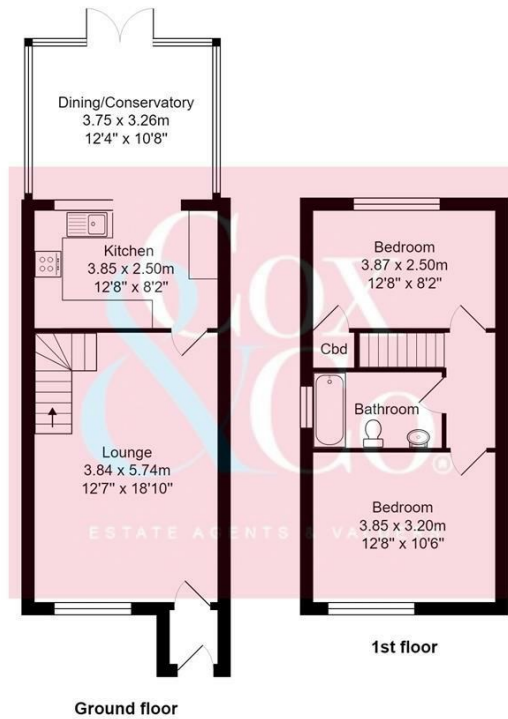

- Two Bedroom End of Terraced House
- Modern Fitted Kitchen
- Two Double bedrooms
- Popular Family Location
- Excellent Transport Links
- Conservatory Diner
- Lounge
- Garage
- South Facing Rear Garden

# Bush Farm Drive, Portslade, Brighton

Price: £325,000 Freehold



Total Area: 79.4 m<sup>2</sup> ... 855 ft<sup>2</sup>

All measurements are approximate and for display purposes only. Copyright 'GREEN PROPERTIES' 2021

Cox & Co are pleased to offer this lovely two double bedroom end of terraced family home located in the heart of the Downs View area of Portslade.

The property is in excellent decorative order throughout.

The accommodation comprises a good size lounge with a modern fitted kitchen opening up onto a conservatory dining room extension that directly overlooks the south facing rear garden. On the first floor, there are two double bedrooms and a lovely modern family bathroom.

Outside the property has a south facing rear garden and rear access to the garage which is located directly behind the property.

For viewing please contact Cox & Co on 01273 00 99 66

