

Church Road, BN41

Approximate Gross Internal Area = 86.4 sq m / 930 sq ft

Garage = 18.8 sq m / 202 sq ft

Workshop = 14.8 sq m / 159 sq ft

Total = 120.0 sq m / 1291 sq ft

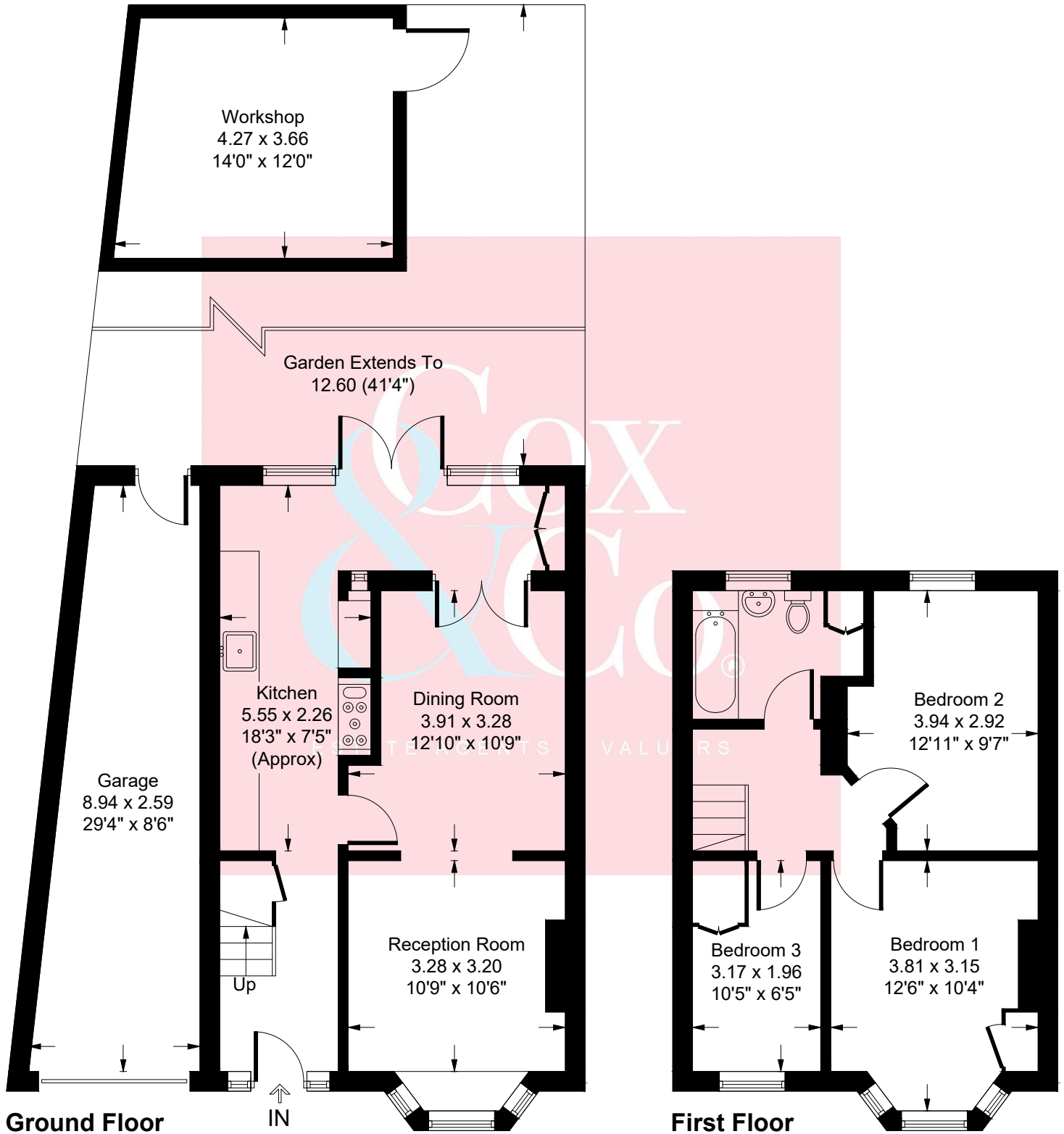

This floor plan is for representation purposes only as defined by the RICS code of Measuring Practice (and IPMS where requested) and should be used as such by any prospective purchaser. Whilst every attempt has been made to ensure the accuracy contained here, the measurement of doors, windows and rooms is approximate and no responsibility is taken for any error, omission or mis-statement. Specifically no guarantee is given on the total area of the property if quoted on the plan. Any figure provided is for guidance only and should not be used for valuation purposes.