

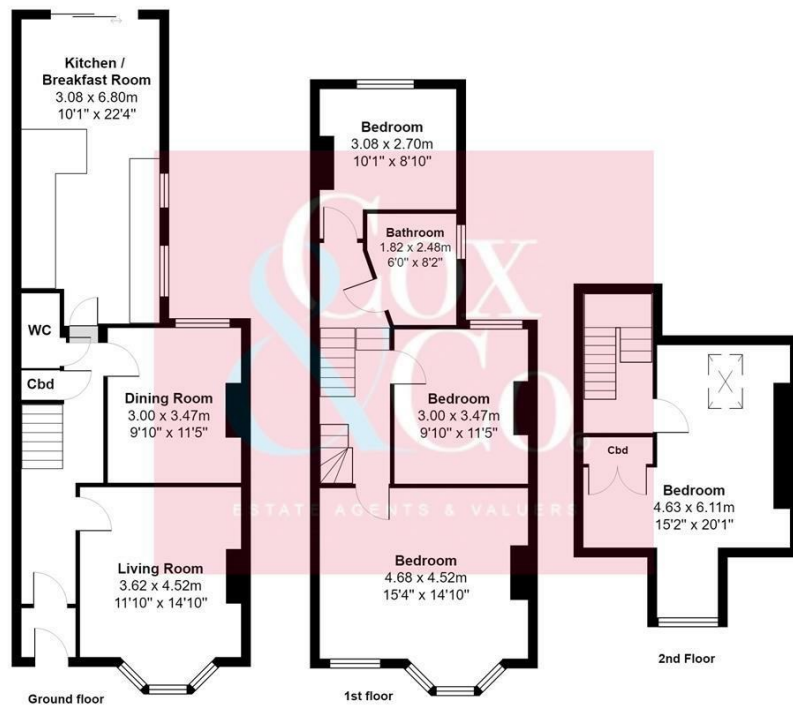

- Four Bedroom Period House
- Close To Mainline Train Station
- Sought After Location
- Potential To Add Value (STP)
- Four Double Bedrooms
- South Facing Rear Garden
- Kitchen & Breakfast Room
- Lounge & Separate Dining Room
- Downstairs WC
- Must Be Viewed

St. Aubyns Road, Portslade, Brighton

Price: £650,000 Freehold



Total Area: 135.7 m² ... 1461 ft²
 All measurements are approximate and for display purposes only

Cox & Co are pleased to offer this four-bedroom terraced period house that is offered for sale in excellent decorative order throughout.

The spacious accommodation comprises on the ground floor a lounge and separate dining room, a lovely modern kitchen and breakfast room overlooking the rear south facing garden plus a separate WC, on the first floor three double bedrooms and a family bathroom with a further double bedroom on the second floor

Outside there is a south-facing rear garden and to the front a formal front garden.

All four of the bedrooms are doubles making this an ideal family home.

The property is ideally located just off Boundary Road in West Hove and is very close to shops, bars, and cafés. Portslade mainline railway station is only 0.2 miles away with regular direct services to both Brighton & London city centres. There are also excellent bus services into Brighton & Hove city centres close by from New Church Road.

There has recently been a soft light touch parking scheme introduced into the area which has improved the parking.

