

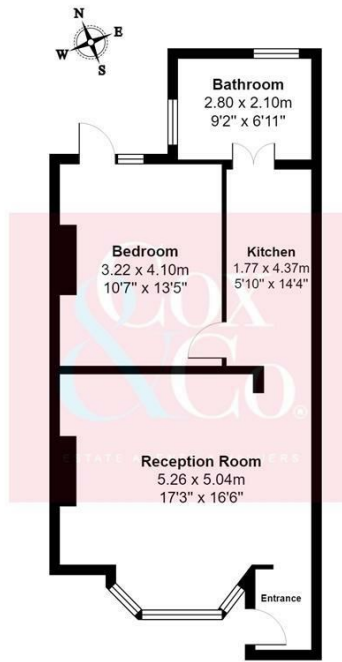

- Lower Ground Floor Garden Flat
- Good Size Living Room
- Popular & Central Location
- Share Of The Freehold
- Close To Hove Station
- Private Rear Garden
- Double Bedroom
- No Onward Chain
- New Lease

## Lorna Road, Hove

Price: £250,000 Share of Freehold



Total Area: 55.0 m<sup>2</sup> ... 592 ft<sup>2</sup>

All measurements are approximate and for display purposes only

Cox & Co are pleased to bring to the market this well-presented basement flat centrally located as it's only 0.5 miles from Hove Station and 0.7 miles from Hove seafront.

The flat offers a bright and spacious living area that is bay fronted, with the original wooden flooring with spotlighting. This leads to a modern fitted kitchen, with a combination of shelving and low-level cabinets. There is a double bedroom which has access to the rear garden which is private to the flat and a family bathroom.

The seller informs us that the property is being sold with a new lease with a share in the freehold and a brand new lease.

