



- Detached Family Home
- West Facing Rear Garden
- Large Open Plan Family Room
- Bathroom Plus Additional Shower Room
- Excellent Decorative Order Throughout
- Three/Four Bedrooms
- Garage & Private Drive
- Modern Fitted Kitchen
- Very Popular Location
- Must Be Viewed

St Helens Crescent, Hangleton,

Hove

Price: £650,000 Freehold

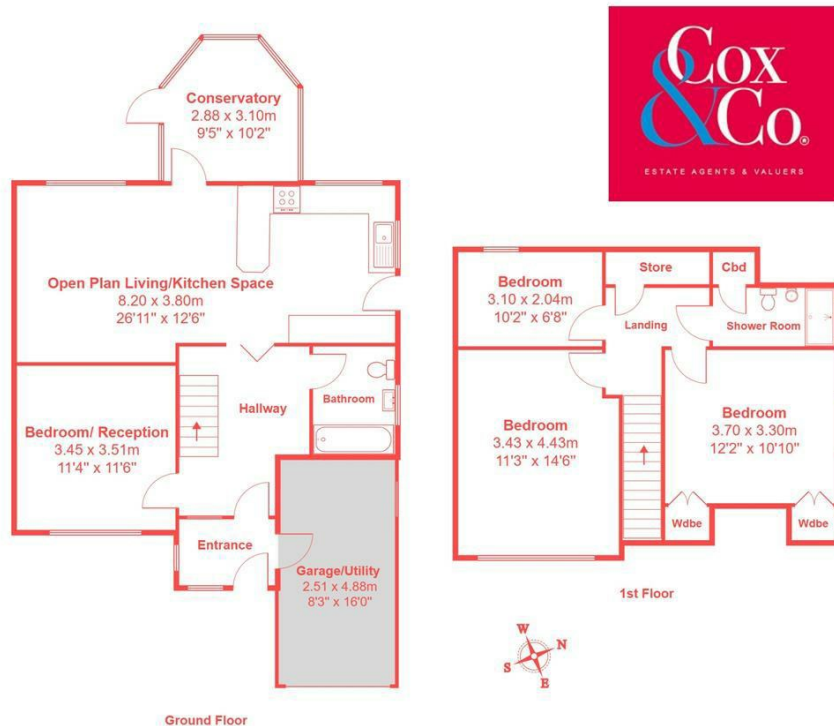

Total Area: 117.0 m² ... 1259 ft² (excluding Garage/Utility)
 All measurements are approximate and for display purposes only

Cox & Co is pleased to bring this versatile three/four-bedroom detached house to the market. The property is in a very popular residential location, with a good-sized rear garden, garage approached via a private drive and lovely views across the south downs.

You enter the property into a good-sized hallway, and straight in front of you is a lovely open-plan family room incorporating a modern fitted kitchen with a breakfast bar, a door giving side access and a large window with excellent views across the garden and the South Downs National Park. There is a large conservatory directly off the lounge area which could easily be used as a dining room or children's play room. There is a downstairs bedroom or an additional snug/living room, family bathroom and WC and the door to the garage/utility room.

On the first floor, there is a lovely light landing, three bedrooms, and a shower room. Outside, you have a good-sized west-facing garden, mainly laid to lawn, with various flower and shrub borders. To the front, you have a private drive leading to a good-sized garage.

For Viewings, please get in touch with Cox & Co.

