

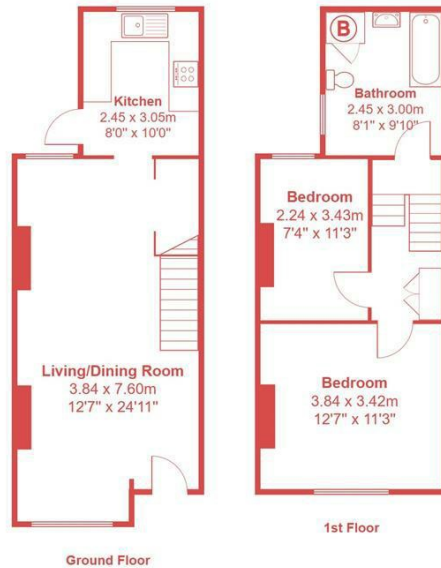

- Two Bedroom Period End Of Terrace Town House
- Private Off Street Parking
- Newly Fitted Kitchen & A Newly Installed Flat Roof
- Open Plan Through Lounge/Diner
- Large Rear Garden
- Two Double Bedrooms
- Popular Family Location With Great Schools Close By
- Large Newly Renovated Family Bathroom
- Must Be Viewed

Underdown Road, Southwick, Brighton

Price: £400,000 Freehold



Total Area: 72.4 m² ... 780 ft²

All measurements are approximate and for display purposes only

Cox & Co are delighted to bring this well-presented two-bedroom end-of-terraced semi-detached house to the market. The property has been renovated by the current owners, and the property benefits from having a newly fitted kitchen and a large modern bathroom suite.

Downstairs, you have a lovely south-facing open-plan Lounge & dining room with a door through to the modern fitted kitchen with a range of integrated appliances and a large window giving views over the rear garden. On the second floor are two double bedrooms, a large newly renovated family bathroom, and a newly fitted flat roof, which the current owners installed.

There is private off-street parking and a sizeable rear garden outside the property.

Ideally situated near the historic Southwick Green with its interesting listed buildings and within walking distance of comprehensive shopping facilities in Southwick Square and Southwick Railway Station. There are also some fantastic schools just around the corner.

The Holmbush Centre. Brighton and Worthing are to the East and West respectively. Whilst the centre of Shoreham is approximately 1.7 miles away.

For viewings, please get in touch with Cox & Co.

