

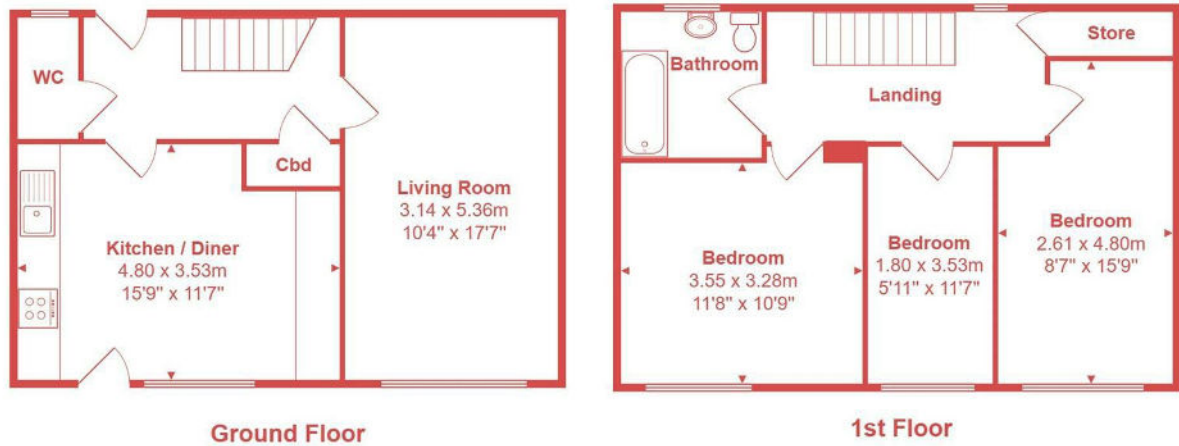

- Semi Detached Home
- South Facing Garden
- Good Storage
- Front and Rear Access
- Three Well Sized Bedrooms
- Large Living Space
- Gas Central Heating
- Close To South Downs National Park

Flint Close, Portslade, Brighton

Price: £325,000 Freehold



Total Area: 88.4 m² ... 951 ft²

All measurements are approximate and for display purposes only



Welcome to this charming semi-detached house nestled in the neighborhood of Flint Close, Portslade. This delightful house presents an excellent opportunity to create your ideal home, with three well sized bedrooms and a delightful south-facing garden.

Upon entering, you're greeted by a spacious and inviting hallway. The living room offers ample space for relaxation and entertaining guests with a nice view of the garden. Adjacent is the generously sized kitchen which also offers access to the garden. A convenient storage cupboard and a downstairs toilet off the hallway provide added functionality to the ground floor layout.

Ascending the staircase, you'll discover three well-proportioned bedrooms. A decent storage cupboard ensures ample space for organizing belongings, while a loft space provides further storage solutions.

Externally, the south-facing garden is a great size and offers another access point to the property.

Although the house is in good condition, this property presents an opportunity for some modernization, allowing you to infuse your personal style and preferences into the space.

Conveniently located in Portslade, this residence enjoys easy access to local amenities, schools, parks, and transportation links, ensuring a convenient and fulfilling lifestyle for its fortunate occupants.

