

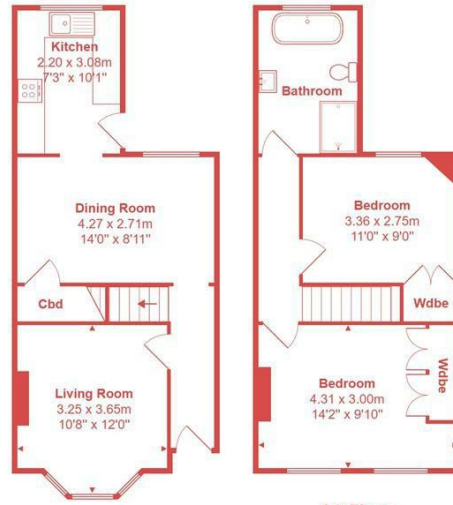

- Immaculately Presented Two Bedroom House
- Two Spacious Double Bedrooms
- Double Glazing With Shutters
- Shed With Power and Light
- Stunning Garden
- Modern Bathroom With Underfloor Heating
- Loft Room
- Great Storage

# St. Peters Road, Portslade, Brighton

Price: £375,000 Freehold



Ground Floor

1st Floor

Total Area: 72.1 m<sup>2</sup> ... 776 ft<sup>2</sup>

All measurements are approximate and for display purposes only

Nestled along the charming St. Peters Road in Portslade, this mid-terrace house presents an exceptional opportunity for comfortable and convenient living in a sought-after location.

Upon entering, you are greeted by a spacious living room that exudes warmth and character. Featuring an exposed brick chimney breast, shutters, and a large bay window, this inviting space offers the perfect setting for relaxing evenings or entertaining guests.

Continuing through the ground floor, the dining room, positioned towards the rear of the house, offers ample space for hosting family meals or dinner parties. Adjacent to the dining room, the well-appointed kitchen provides easy access to the garden, making outdoor dining and entertaining a breeze.

Ascending to the first floor, the large primary bedroom is a great size with fitted wardrobes and ample space for a comfortable retreat. Accompanying the primary bedroom is a generously sized second bedroom, complete with storage solutions to accommodate all your needs.

The highlight of the first floor is the beautifully maintained bathroom, showcasing a large walk-in shower and a charming clawfoot bath, providing a luxurious escape for relaxation. Completing the bathroom are a w/c and basin.

Stepping outside, you'll discover a fantastic garden, offering an abundance of space for outdoor activities, gardening, or simply soaking up the sunshine. With its impeccable condition, the garden presents an idyllic setting for al fresco dining or relaxation. There is also a shed which has power, lights and ventilation.

