

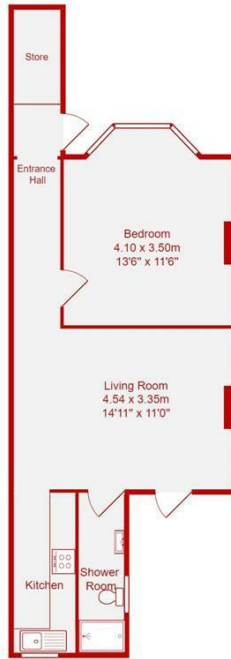

- **Stunning Lower Ground Floor One Bedroom Apartment**
- **Large Living Space**
- **Modern Separate Kitchen**
- **Close To Homefield Park**
- **Close to Worthing Station**
- **Spacious Bedroom**
- **Fantastic South Facing Garden**
- **Modern Bathroom**
- **Close to Worthing Hospital**
- **No Chain**

## Newland Road, Worthing

Price: £190,000 Leasehold



Total Area: 43.2 m<sup>2</sup> ... 465 ft<sup>2</sup>

All measurements are approximate and for display purposes only.

Welcome to this delightful lower ground floor flat on Newland Road, Worthing, offering a perfect blend of modern comfort and convenient location.

You enter the apartment with its own private entrance and a spacious hallway. The large bedroom, situated at the front of the property with plenty of space for storage.

At the rear, the generous living room opens out onto an immaculate, south-facing garden—ideal for enjoying sunny afternoons and alfresco dining.

The modern separate kitchen, which overlooks the garden, is well-equipped and thoughtfully designed for both functionality and style. Next to the kitchen, the contemporary bathroom features sleek finishes and modern fixtures.

This flat is ideally positioned close to Worthing Station, Homefield Park, and a variety of shops, including the convenient Waitrose. Whether you're commuting or exploring local amenities, this location offers both accessibility and comfort.

Leasehold - 106 Years  
Service Charge - £1,200

