

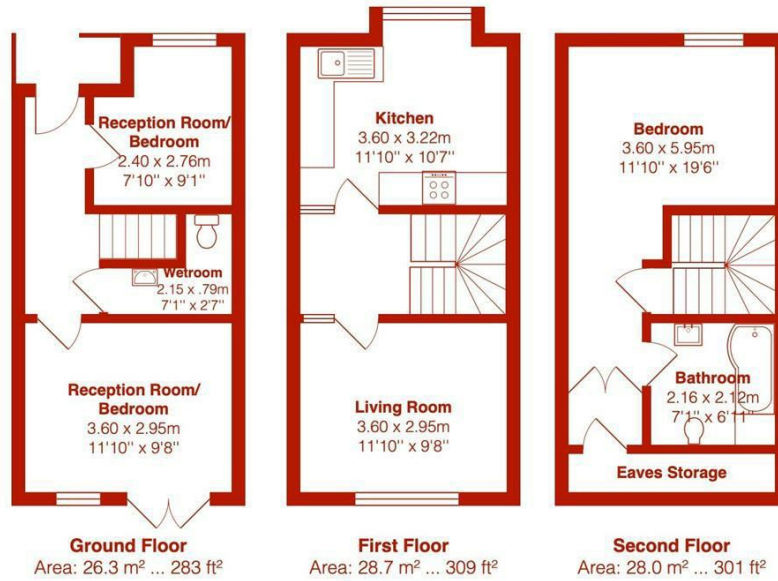

- No Chain
- Three Bedrooms
- South Facing Courtyard
- Central Kemp Town Village
- Close To Royal Sussex County Hospital
- Three Storey Townhouse
- Two Bathrooms
- Close To The Sea
- In Need Of Some Modernisation
- 82.9 Sq Meters/893 Sq Feet

## Bloomsbury Street, Brighton

Price: £450,000 Freehold



Total Area: 82.9 m<sup>2</sup> ... 893 ft<sup>2</sup>

All measurements are approximate and for display purposes only

Nestled in the vibrant heart of Kemp Town Village, this charming three-storey townhouse on Bloomsbury Street offers an exciting opportunity to create your dream home. Just a short stroll from the seafront, and surrounded by an array of delightful cafes, bakeries, and eateries, this property is ideally located for those seeking the best of Brighton's coastal lifestyle. The Royal Sussex County Hospital is also close by, with excellent bus links providing easy access to central Brighton.

Upon entering the home, you are greeted by a spacious hallway. To your left is a double bedroom, while towards the rear of the ground floor lies a second bedroom, complete with direct access to a south-facing courtyard. This floor also benefits from a shower room, offering convenience for guests or additional family members.

On the first floor, the separate kitchen provides plenty of scope for customisation, and the generously sized living room, with its bright south-facing aspect.

The second floor features the primary double bedroom, which boasts an en-suite bathroom for added comfort and privacy.

The property is being offered with no forward chain and presents an exciting opportunity for modernisation, allowing you to put your own stamp on this characterful home in one of Brighton's most sought-after areas.

