

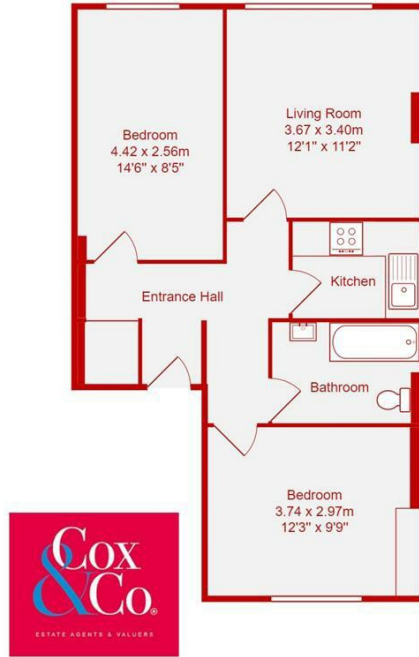

- Two Bedroom Second Floor Flat
- Close to Hove Mainline Train Station
- Two Double Bedrooms
- Well Maintained Block
- Central Hove Location
- Share Of Freehold
- Walking Distance To The Sea

Denmark Villas, Hove

Price: £325,000 Leasehold - Share of Freehold



Total Area: 53.8 m² ... 579 ft²
 All measurements are approximate and for display purposes only.

This charming two-bedroom second-floor flat is located on Denmark Villas, in the heart of Hove. Upon entering, you're greeted by a spacious hallway, offering ample storage space and setting the tone for the well-laid-out apartment.

At the front of the property, the bright and airy living room features west-facing sash windows, providing lovely views and plenty of natural light. The separate kitchen, conveniently situated off the hallway, has good countertop space, ample cabinets, and room for essential appliances including a cooker, fridge freezer, and washing machine.

The bathroom is well-sized, complete with a bath and shower overhead, a basin, and a WC. The primary bedroom is a fantastic double room, also west-facing, with space for a wardrobe and plenty of natural light. The second bedroom, another spacious double, benefits from an east-facing sash window, making it ideal for guests, a home office, or additional living space.

The location of this apartment is second to none. Hove mainline railway station has direct access to both Brighton and London and is only a 3-minute walk or 0.1 miles away. The popular Church Road and George Street, with their vast range of independent retailers, coffee shops, bars, and restaurants are only a couple of minutes' walk away. Hove seafront and lawns are less than 10 minutes or 0.6 miles away. There are direct bus links across the city from just around the corner.

Lease - 999 Year Term
 Share Of Freehold
 Service Charge - £1,200 per year.

Energy Efficiency Rating		Current	Potential
Very energy efficient - lower running costs			
(92 plus) A			
(81-91) B			
(69-80) C		76	83
(55-68) D			
(39-54) E			
(21-38) F			
(1-20) G			
Not energy efficient - higher running costs			
England & Wales		EU Directive 2002/91/EC	

