

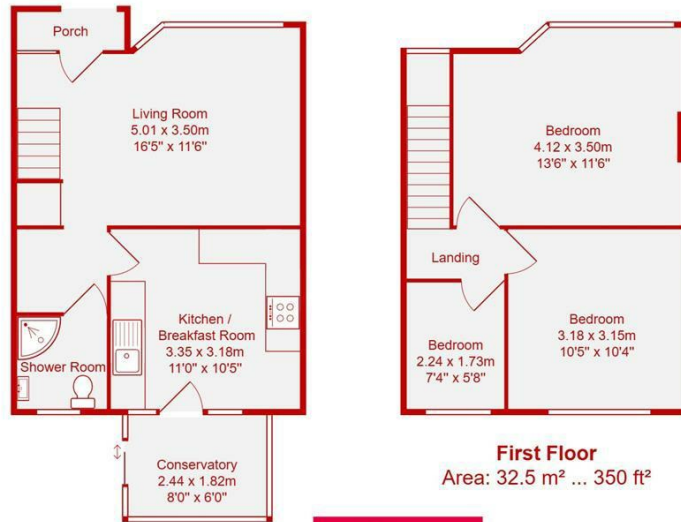

- No Chain!
- Large West Facing Garden
- In Need Of Modernisation
- Fishersgate station is 0.2 miles away (5 minute walk approx.)
- Three Bedroom Terraced Home
- Double Garage And Parking Space
- Quiet Road
- New Boiler

Crown Road, Portslade

Price: £280,000 Freehold



Total Area: 70.0 m² ... 754 ft²

All measurements are approximate and for display purposes only.

Nestled on the peaceful and sought-after Crown Road in Portslade, this three-bedroom mid-terraced house offers an exciting opportunity for buyers looking to create their dream home. In need of modernisation, this property has a spacious west-facing garden and a large double garage, providing ample room to accommodate modern vehicles.

On the ground floor, you'll find a generous living room at the front of the house. To the rear, a good-sized kitchen leads out to the garden, offering a seamless connection between indoor and outdoor spaces. Adjacent to the kitchen is a convenient shower room. For added practicality, the property benefits from side access, leading to the garage and an additional garden entrance.

Upstairs, the home features two large double bedrooms, providing plenty of space for family or guests, along with a single bedroom ideal for a home office or child's room.

This property is sold with no onward chain, making it an attractive proposition for those ready to begin the journey of transforming it into a modern family home.

The house is located in a quiet part of Portslade with excellent travel links and amenities close by. There is a short walk to St Nicholas and Brackenbury Primary school with plenty of options for secondary. Fishersgate station is 0.2 miles away (5 minute walk approx.)

| Energy Efficiency Rating | | Current | Potential |
|---|--|-------------------------|-----------|
| Very energy efficient - lower running costs | | | |
| (92 plus) A | | | 89 |
| (81-91) B | | | |
| (69-80) C | | 71 | |
| (55-68) D | | | |
| (39-54) E | | | |
| (21-38) F | | | |
| (1-20) G | | | |
| Not energy efficient - higher running costs | | | |
| England & Wales | | EU Directive 2002/91/EC | |

