

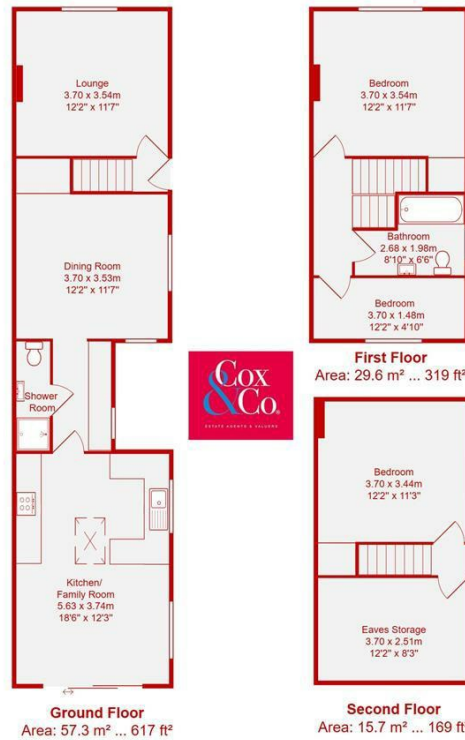

- **Stunning Extended Period Town House**
- **Close To Mainline Station**
- **Lovely Modern Kitchen & Family Room**
- **Large Landscaped Rear Garden**
- **Very Popular & Central Location**
- **Three Bedrooms**
- **Three Reception Rooms**
- **Private Off Street Parking For Two Cars**
- **Close To Local Shops, Cafe's Bar's & Restaurants**
- **Downstairs Shower & Wc**

## Vale Road, Portslade

Price: £550,000 Freehold



**Total Area: 102.6 m<sup>2</sup> ... 1105 ft<sup>2</sup> (excluding eaves storage)**  
All measurements are approximate and for display purposes only.

Cox & Co are pleased to bring this superb three-bedroom extended period townhouse to the market. As you enter the property, you can turn left or right into one of the reception rooms; the lounge is to your right, and the dining room is to the left. You then walk through the modern kitchen and family room with views of the rear garden. You have a utility area, a downstairs shower room and a WC.

On the first floor, you have the main bedroom, and the third single room is currently used as an office and has a large family bathroom.

On the top floor, another double bedroom and a large loft area which could be converted into another bedroom or a bath/ shower room, subject to permissions.

Outside, you have private off-street parking for two cars and a large landscaped rear garden.

