



ESTATE AGENTS & VALUERS

61 Boundary Road
Hove
Sussex
BN3 5TD

01273 00 99 66
coxandcohomes.co.uk



- No Chain
- Three Bedrooms
- Recently Refurbished
- Close to Fishersgate Station
- Immaculately Presented
- West Facing Garden
- Great Location
- New Kitchen And Bathroom

Crown Road, Portslade

Price: £385,000 Freehold

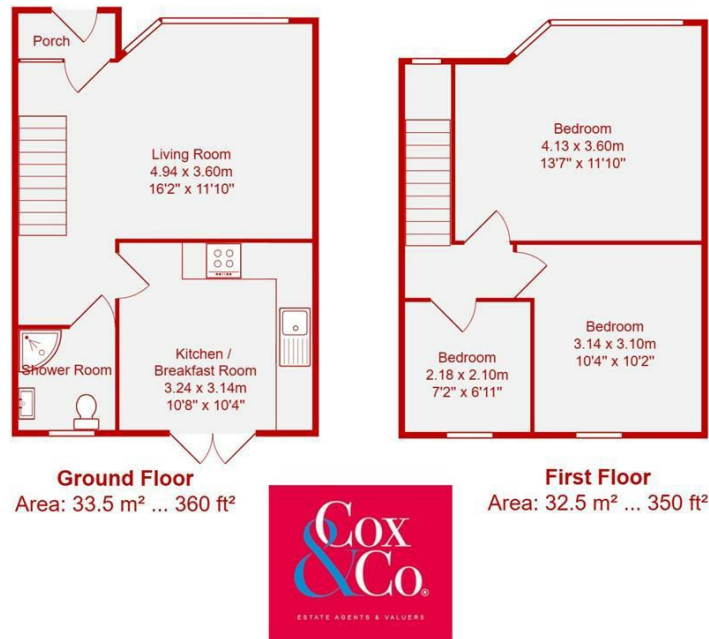

All measurements are approximate and for display purposes only.

This immaculate three-bedroom terraced home has been recently modernised throughout and is ready to move straight into. Boasting a stylish interior and a sun-soaked West-facing garden, this property offers the perfect blend of comfort, space, and convenience.

As you step inside, you're welcomed by a bright and spacious living room to the front – ideal for relaxing or entertaining. To the rear, the heart of the home is a stunning, newly fitted modern kitchen featuring sleek finishes and French doors that open directly onto the West facing garden, flooding the space with natural light and creating a seamless indoor-outdoor flow.

A contemporary downstairs shower room is conveniently located just off the hallway, offering practicality without compromising on style.

Upstairs, you'll find two generously sized double bedrooms, both beautifully presented, along with a well-proportioned single bedroom perfect for a child's room, home office, or guest space.

With every detail thoughtfully updated and maintained to the highest standard, this is a truly turnkey home in exceptional condition.

The house is located in a quiet part of Portslade with excellent travel links and amenities close by. There is a short walk to St Nicholas and Brackenbury Primary school with plenty of options for secondary. Fishersgate station is 0.2 miles away (5 minute walk approx.)

Energy Efficiency Rating		
	Current	Potential
Very energy efficient - lower running costs		
(92 plus) A		89
(81-91) B		
(69-80) C		
(55-68) D		
(39-54) E		
(21-38) F		71
(1-20) G		
Not energy efficient - higher running costs		
England & Wales		EU Directive 2002/91/EC