

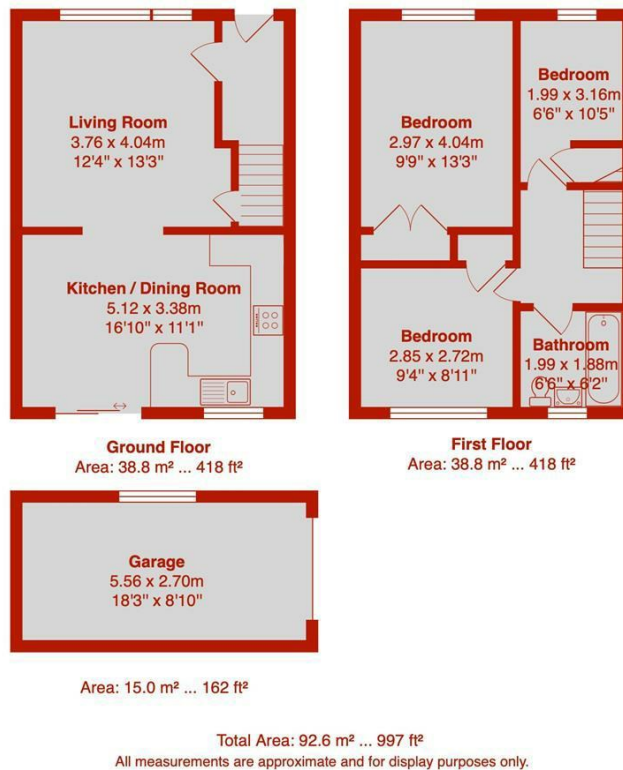

- Three Bedroom Semi-Detached Family Home
- Garage & Hard Standing
- Popular Location
- Modern Kitchen
- Modern Family Bathroom
- Open Plan Kitchen/Diner
- Landscaped Rear Garden
- New Boiler Installed July 21
- Located in a Close
- Must Be Viewed

Bush Cottage Close, Portslade

Price: £350,000 Freehold



Nestled in a peaceful close, this spacious three-bedroom semi-detached home offers comfortable modern living in a quiet and convenient location.

On entering, you are welcomed by a hallway that leads into an inviting open-plan living room and contemporary kitchen. This generous space is perfect for both relaxing and entertaining, with sleek finishes and sliding doors that open directly onto a large patio garden—ideal for outdoor dining and enjoying the sunshine. The garden also benefits from a rear access gate leading to off-road parking and a substantial garage, providing excellent storage or workshop/office potential.

Upstairs, the property features three well-proportioned bedrooms, including two doubles and a versatile single bedroom, perfect for a child's room, home office, or guest space. The family bathroom is fitted with a shower over bath, WC and basin.

Beautifully maintained throughout, this lovely home sits in a sought-after spot close to the South Downs, with convenient bus links into Brighton & Hove. A perfect choice for those seeking space, tranquility and easy access to both countryside and city amenities.

